

Window Replacement in Masonry Wall

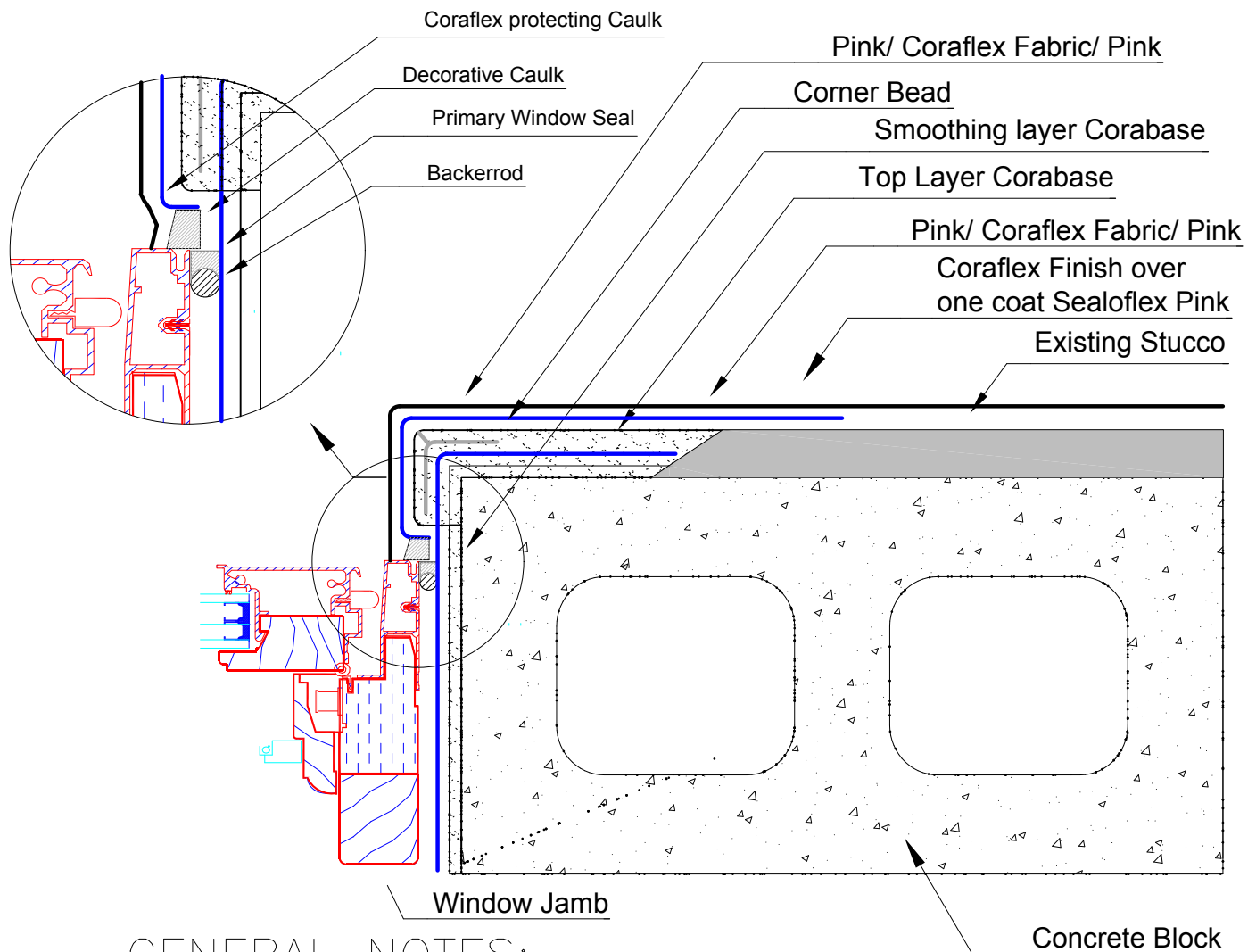

GENERAL NOTES:

- APPROVED FOR ALL SEALOFLEX WARRANTIES
- FOLLOW STEPS FOR ANY NECESSARY PRIMING AS OUTLINED IN SPECIFICATIONS MANUAL
- FOLLOW STEPS FOR APPLICATION AS OUTLINED IN SPECIFICATIONS MANUAL
- ALL SEALOFLEX FABRIC TO OVERLAP A MIN. OF 3" WHEN TWO PIECES COME TOGETHER
- ALL SEALOFLEX FABRIC TO OVERLAP A MIN. OF 3" WHEN THERE IS A CHANGE IN PLANE
- USE TWO SEPARATE PIECES OF SEALOFLEX FABRIC AT EDGES AND PENETRATIONS