

2.3.4 Planters

Application Guide

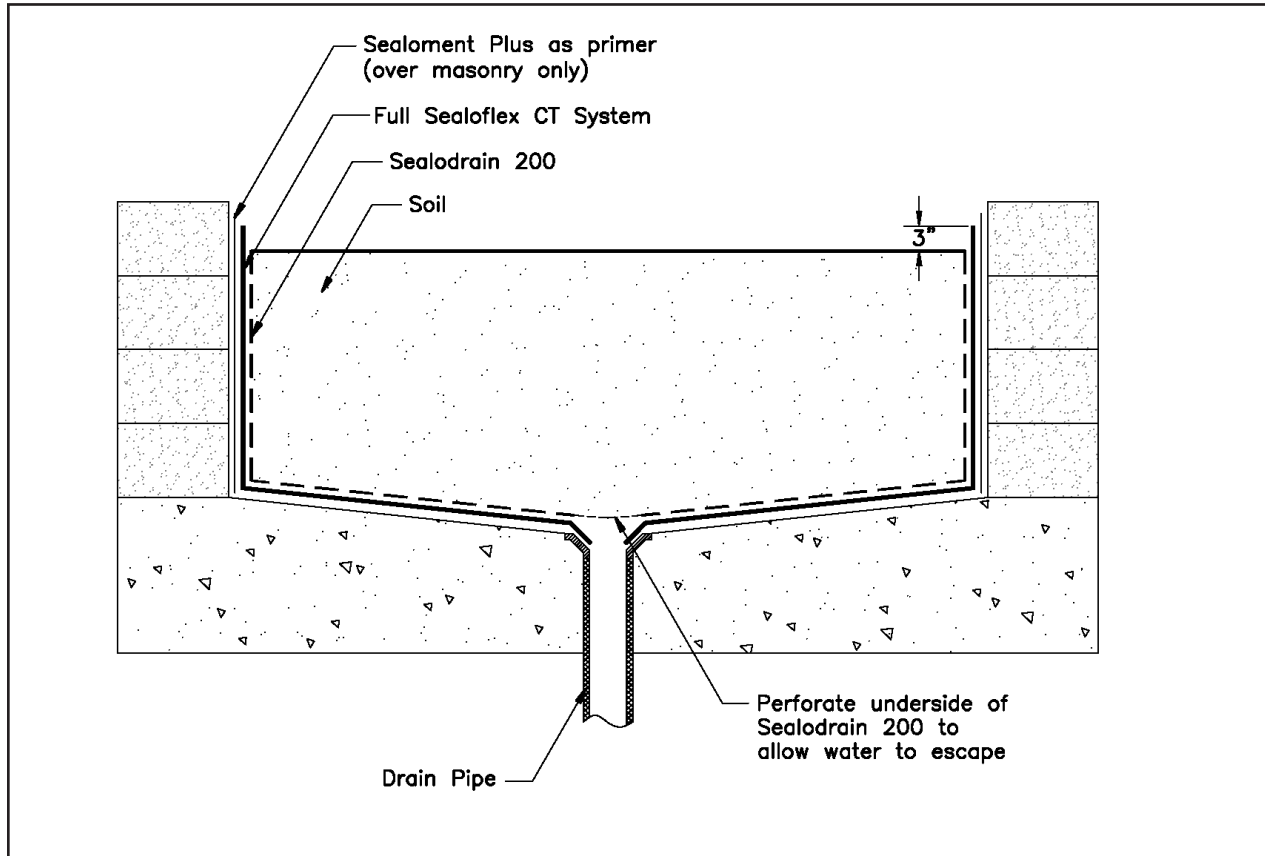

Planter Categories

In this section the planters can be divided into three specific categories:

- Wooden Surfaces
- Existing Planters with previous waterproofing
- New Masonry Surfaces

Preparation

Wooden Planters

The Sealoflex CT System™ may be applied directly to the boards forming the interior of the planter. Ensure that the surfaces are clean, dry and free of loose particles.

Existing Planters

Remove all loose and unadhered material from the interior walls of the planter and clean thoroughly.

Masonry Walls

Dampen interior surfaces thoroughly and apply a generous coat of Sealoment Plus™. Allow to cure for at least 72 hours before applying the Sealoflex CT System™.

Application

Waterproofing System

Ensure that the surfaces are **completely dry** before applying the Sealoflex CT System™.

- Precut Sealoflex Fabric™ to suit the wall and floor surfaces of the planter. Fabric must be sufficiently long to overlap adjacent runs of fabric by a minimum of 3" and also should terminate 3" above the intended soil level.
- Using brush or roller apply a moderate coat of Sealoflex CT Pink™ to the wall and floor surface. Immediately embed the pre-cut fabric into the wet Sealoflex CT Pink™

using gloved hands or a dry brush.

Ensure that any bubbles or wrinkles are smoothed out at this point.

Adjacent runs of fabric are applied in the same way overlapping by at least 3". Ensure that overlaps of fabric are fully saturated. At the drain outlet, star cut the fabric over the drain opening and adhere the cut excess fabric down into the drain opening. Cut further small appropriately shaped pieces of fabric to further seal the waterproofing system into the drain interior. Continue until the entire interior area of the planter is covered in this way. Allow to dry.

- Using brush or roller, apply a generous coat of Sealoflex CT Pink™ to the top of the fabric in order to fully saturate the fabric. Allow to dry.
- Apply 2 coats of Sealoflex CT Top™ to the entire area. Allow to cure before covering with Sealodrain 200™ and filling with soil.

SEALOFLEX INC.

CORPORATE OFFICES

2520 Oscar Johnson Drive
Charleston, SC 29405
Tel: (843) 554-6466
(800) 770-6466
Fax: (843) 554-6458
Website: www.Sealoflex.com
E-mail: info@sealoflex.com

SALES OFFICE

CHARLESTON, SC
HAMBURG, GERMANY
CANTERBURY, KENT, U.K.

Sealoflex®

Waterproofing Systems

LIMITED WARRANTY

Sealoflex warrants its products to be free of manufacturing defects and that they will meet Sealoflex's current published physical properties when applied in accordance with Sealoflex's directions. There are no other warranties by Sealoflex of any nature whatsoever, expressed or implied, including any warranty of merchantability of fitness for a particular purpose in connection with this product. Sealoflex Inc. shall not be liable for damages of any sort, including remote or consequential damages, resulting from any claimed breach of any warranty whether expressed or implied, including any warranty of merchantability of fitness for a particular purpose or from any other cause whatsoever.

FEBRUARY 2010

Drainage System

- Precut sheets of Sealodrain 200™ to accurately fit the planter surfaces, such that the top edge of the Sealodrain 200™ will protrude 1" above the intended soil level. Where possible, allow the Sealodrain 200™ to remain continuous from the wall to the floor. At the intersection line of the floor/wall/planes, cut the dimpled plastic back of the Sealodrain 200™, without cutting the geofabric top surface. This will allow the Sealodrain 200™ to make the transition from one plane to another.
- It may be necessary to adhere the individual pieces of Sealodrain 200™ to the walls, as a temporary measure. Should this be the case use a single part polyurethane caulk or adhesive. **DO NOT** use solvent containing caulks or adhesives.
- Where two separate pieces of Sealodrain 200 meet in a corner, apply a piece of 4" Sealoflex Jointing Fabric™ and Sealoflex CT Pink™ symmetrically across the joint to adhere into position.
- At the position of the drain opening, the dimpled black plastic backing of the Sealodrain 200™ must be carefully cut out to coincide with the position of the drain. This is very important, as this opening will allow the excess water collected by the drainage mat to escape freely into the drain. See drawing on the front of this page.

IMPORTANT NOTES:

- **DO NOT** seal off the top of the drainage mat where it protrudes above the soil level. This must remain open to allow airflow.
- Once the drainage mat is firmly in position, carefully fill the planter with the appropriate soil.

NOTE: Once the Sealoflex CT™ System is applied, ensure that all work that follows is carefully undertaken so as not to damage the waterproofing system.

WARNING!

DO NOT plunge, submerge, dip, etc. applicator tools (rollers, brushes, etc.) into CT™ Buckets due to static electricity buildup. Sparks/Fire may result. Always **pour** CT™ products from the container onto the substrate.

CT™ PRODUCTS ARE FLAMMABLE!

Electrostatic charge may accumulate and create a hazardous condition when handling or applying CT™ Products.

**ALWAYS USE PROPER
GROUNDING PROCEDURES.**

**ALWAYS HAVE A CO₂ FIRE
EXTINGUISHER WITHIN
IMMEDIATE REACH OF THE
APPLICATION AREA.**

For this and/or related products, please refer to individual product data sheets, System Application Guides, Products MSDS, Primer Chart, Fabric Chart.

IMPORTANT NOTE: Always check our website, www.sealoflex.com to determine if the printed literature you are reading is the most current version available.