

1.4.2 Gutters

Application Guide

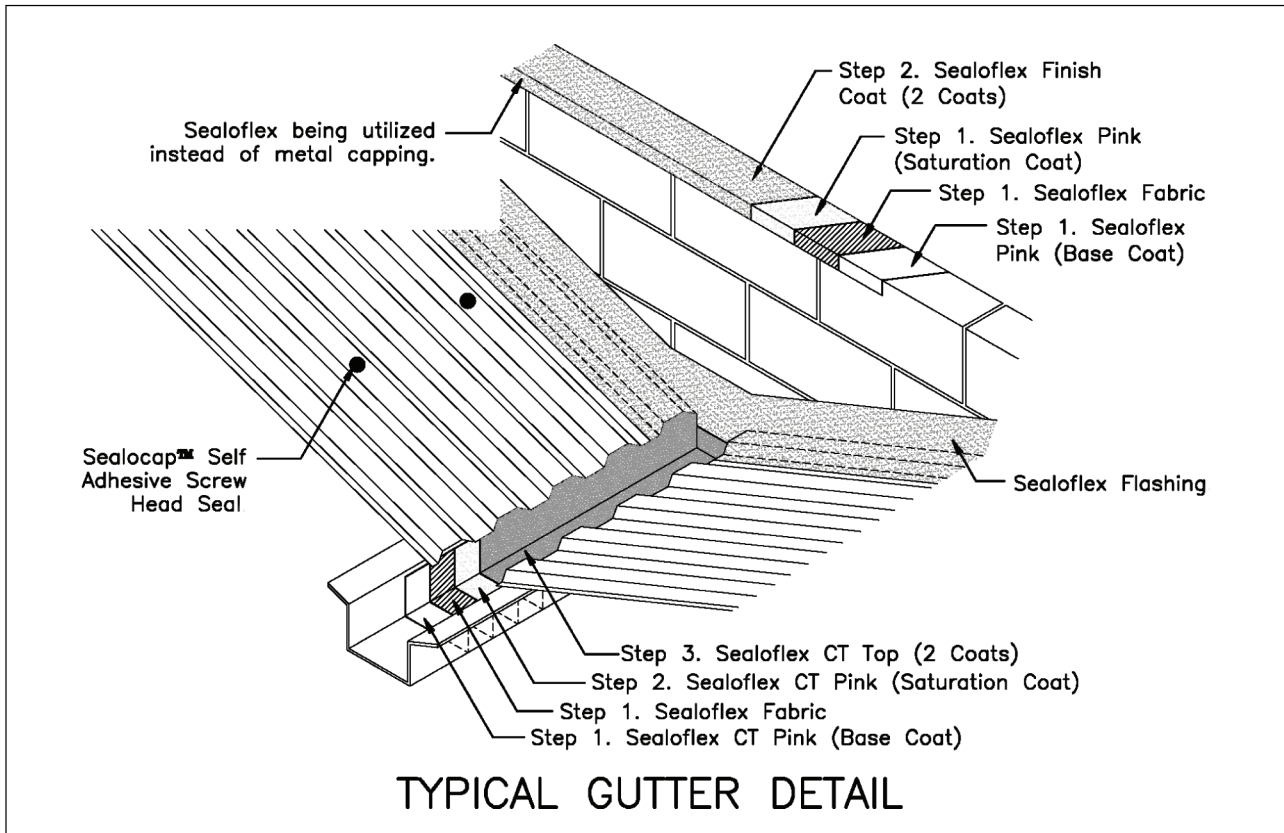

Inspection

Inspect the gutter with reference to the following items:

- Verify that gutter supports are intact
- Verify whether gutter sections are welded or joined together
- Check for holes and extent of rust

Preparation

Remove dirt and all foreign matter from the interior of the gutter. Surfaces should be clean and free of loose paint, oil, and grease. Wire brush all rusted areas to remove loose rust.

NOTE: Low areas on both wood and concrete decks can be filled with Sealopatch™ prior to application of fabric reinforcement.

Priming

Prime all previously rusted areas and any other ungalvanized or unpainted ferrous metal with Rust-X 2020™. Allow Rust-X 2020™ to cure for a minimum of 3 hours. Followed by Sealoflex Metal Etch Primer™. Based on substrate and/or surface conditions primers will vary. Primers to consider are Dampseal 101™, Sealobond Primer™, Sealoment Plus™, Rust-X 2020™ and/or Metal Etch Primer™. Refer to Sealoflex Primer chart.

Application of Gutter Lining

Cut the Sealoflex Fabric™ into strips with a width equal to the girth of the gutter. Apply the Sealoflex CT Pink™ by brush to the prepared interior of the gutters in stages and immediately embed the Sealoflex Fabric™ into the wet coating carefully smoothing out any

bubbles or creases with the application brush or rubber gloved hand. Allow to dry. Apply a saturation coat of Sealoflex CT Pink™. Allow to dry. Joints in the Sealoflex Fabric™ should be overlapped by at least 3" minimum. Ensure that overlaps of fabric are fully saturated. Two coats of Sealoflex CT Top™ are then applied over the entire area to complete the lining.

SEALOFLEX INC.

CORPORATE OFFICES

2520 Oscar Johnson Drive
Charleston, SC 29405
Tel: (843) 554-6466
(800) 770-6466
Fax: (843) 554-6458
Website: www.Sealoflex.com
E-mail: info@sealoflex.com

SALES OFFICE

CHARLESTON, SC
HAMBURG, GERMANY
CANTERBURY, KENT, U.K.



Waterproofing Systems

LIMITED WARRANTY

Sealoflex warrants its products to be free of manufacturing defects and that they will meet Sealoflex's current published physical properties when applied in accordance with Sealoflex's directions. There are no other warranties by Sealoflex of any nature whatsoever, expressed or implied, including any warranty of merchantability of fitness for a particular purpose in connection with this product. Sealoflex Inc. shall not be liable for damages of any sort, including remote or consequential damages, resulting from any claimed breach of any warranty whether expressed or implied, including any warranty of merchantability of fitness for a particular purpose or from any other cause whatsoever.

FEBRUARY 2010

Precautions

Read the MSDS sheet on Sealoflex CT™ carefully before application. Avoid contact with eyes and skin. If eyes become contaminated flush with water for at least 15 minutes. If ingested do not induce vomiting and seek medical attention immediately. Use only in well ventilated areas and avoid inhaling vapors. Use of NIOSH approved respirators.

WARNING!

DO NOT plunge, submerge, dip, etc. applicator tools (rollers, brushes, etc.) into CT™ Buckets due to static electricity buildup. Sparks/Fire may result. Always **pour** CT™ products from the container onto the substrate.

CT™ PRODUCTS ARE FLAMMABLE!

Electrostatic charge may accumulate and create a hazardous condition when handling or applying CT™ Products.

**ALWAYS USE PROPER
GROUNDING PROCEDURES.**

***ALWAYS HAVE A CO₂ FIRE
EXTINGUISHER WITHIN
IMMEDIATE REACH OF THE
APPLICATION AREA.***

For this and/or related products, please refer to individual product data sheets, System Application Guides, Products MSDS, Primer Chart, Fabric Chart.

IMPORTANT NOTE: Always check our website, www.sealoflex.com to determine if the printed literature you are reading is the most current version available

1.4.2 February 2010