

## 1.3.1.5 Decks with Colored, Textured, and Hardwearing Finish

### Application Guide

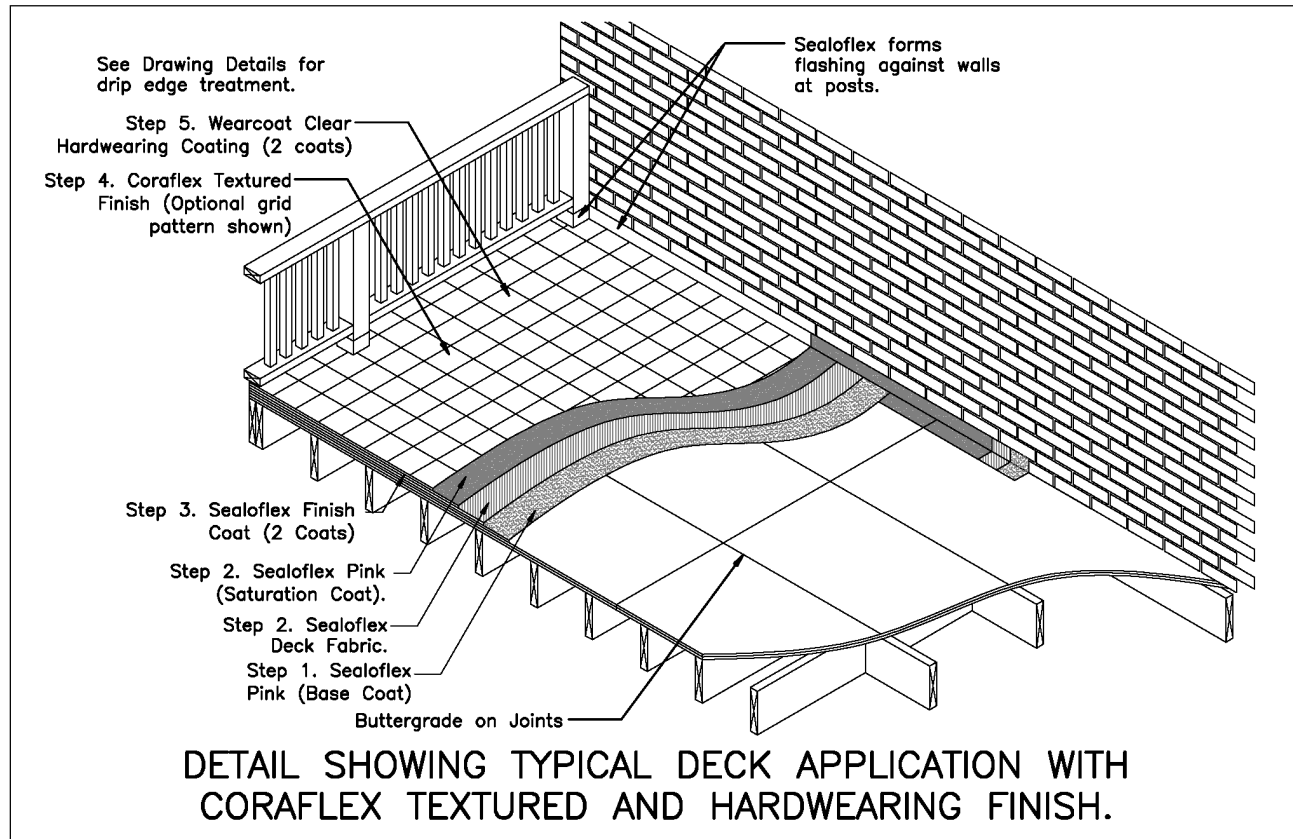

#### Inspection

Inspect deck area carefully paying particular attention to the following points:

- Deck must have adequate slope to ensure proper drainage and no standing water.
- Structural integrity of the deck.

#### Wooden Decks

- The structure should consist of 3/4" tongue and groove exterior grade plywood supported by joists at 16" on center or less
- Joints in the plywood should be over support joists, to eliminate independent vertical movement of the boards

#### Concrete Decks

- Where concrete toppings exist 1/4" expansion joints should be present at least 10 feet on center to accommodate thermal movement and to avoid random cracking of the concrete below the Sealoflex application.
- Where the substrate is reinforced concrete, the location of expansion joints is left to the discretion of the structural engineer.

**NOTE:** Low areas on both wood and concrete decks can be filled with Sealopatch™ prior to application of fabric reinforcement.

#### Preparation

Apply minimum 3/8" x 3/8" fillet of a single component polyurethane caulk at junctions of vertical and horizontal surfaces.

#### Priming

Based on substrate and/or surface conditions primers will vary. Primers to consider are Dampseal 101™, Sealobond Primer™, Sealoment Plus™, Rust X-2020™ and/or Metal Etch Primer™. Refer to Sealoflex Primer chart.

## SEALOFLEX INC.

### CORPORATE OFFICES

2520 Oscar Johnson Drive  
Charleston, SC 29405  
Tel: (843) 554-6466  
(800) 770-6466  
Fax: (843) 554-6458  
Website: [www.Sealoflex.com](http://www.Sealoflex.com)  
E-mail: [info@sealoflex.com](mailto:info@sealoflex.com)

### SALES OFFICE

CHARLESTON, SC  
HAMBURG, GERMANY  
CANTERBURY, KENT, U.K.

# Sealoflex®

## Waterproofing Systems

### LIMITED WARRANTY

Sealoflex warrants its products to be free of manufacturing defects and that they will meet Sealoflex's current published physical properties when applied in accordance with Sealoflex's directions. There are no other warranties by Sealoflex of any nature whatsoever, expressed or implied, including any warranty of merchantability of fitness for a particular purpose in connection with this product. Sealoflex Inc. shall not be liable for damages of any sort, including remote or consequential damages, resulting from any claimed breach of any warranty whether expressed or implied, including any warranty of merchantability of fitness for a particular purpose or from any other cause whatsoever.

FEBRUARY 2010

### Application

- Flash junctions between deck and walls, posts and any other adjacent surfaces with 6" Sealoflex fabric. Apply a generous layer of Sealoflex Pink® 3" minimum up the vertical surface and 3" minimum onto the deck and immediately embed the fabric into the wet Sealoflex Pink® working in well with the paint brush and applying more Pink to the surface to fully saturate the fabric. Allow to dry.
- Repair cracks or imperfections on wood and concrete using Sealoflex Buttergrade™ for minor repairs and Sealopatch™ for larger cavities. Smooth imperfections by applying Sealoflex Buttergrade™ to plywood seams, edges of flashing fabric and drip edge metal using a sheetrock knife or stainless steel trowel. Do not apply thicker than 1/8" at a time. Allow to dry. Sand with 80-100 grit sandpaper to achieve a smooth finish.
- Apply a base coat of Sealoflex Pink® to the entire horizontal area by brush or airless spray at a rate of 100 sq.ft./gal. Allow to dry.
- Unroll the "Deck Fabric" a section at a time. Once the fabric is in position apply Sealoflex Pink® generously to the fabric surface with brush, roller or airless spray equipment and backroll to ensure fabric is properly embedded. Application rate will be approximately 60 sq.ft./gal. When spraying, use a roller to apply pressure to ensure good embedding and saturation of the fabric. Cover the entire horizontal area in this way. Allow to dry. Adjacent runs of fabric must overlap by 3" minimum. Ensure that overlaps of fabric are fully saturated.
- Once the Pink® is dry, trim the excess fabric at the edges with a razor knife. If an overlap of the fabric was necessary, apply Sealoflex Buttergrade™ as described above. At this point, the deck should have smooth uniform appearance showing only the grain of the fabric.
- Apply two generous coats of Sealoflex Finish Coat™ to the whole area and flashings using a brush, roller or airless spray. Allow first coat to dry before applying second coat.
- Ensure that the Sealoflex System™ has cured before applying any decorative finish. (7 days)
- Apply Wearcoat™ (2 coats) allowing each coat to completely dry before subsequent application. Smooth and Non-skid Wearcoat™ options are available.
- Another option to finish the deck surface is using Coraflex™. Coraflex™ offers a textured finish which may be applied in several manners:
  - Coraflex™ may be trowel applied over the entire surface.
  - Coraflex™ may be trowel applied in a grid pattern (as shown in drawing on the front of this page) using vinyl plastic removeable tape. This tape is available from Sealoflex®.
  - Coraflex™ may be applied as a knock-down finish or in other decorative designs.
- Two coats of Wearcoat™, clear or colored, **must** be applied over the Coraflex™ to provide a hardwearing abrasion resistant and cleanable surface.

Contact Sealoflex Technical Department for details.

### Total product requirements for the project will be:

- Sealoflex Pink® 40 sq.ft./gal.
- Sealoflex Finish Coat™ 70 sq.ft./gal.
- Sealoflex Buttergrade™ 1 gal per 150 sq.ft. of deck area (approximately)
- 6" Sealoflex fabric™ 300'/LF roll
- 40" Sealoflex fabric™ 324'/LF roll
- 5' or 10' deck fabric 100 LF/roll
- Wearcoat™ 90 sq.ft./gal.
- Coraflex™ 80-100 sq.ft./5 gal.

### NOTES:

- Do not attempt to saturate two layers of fabric at the overlaps at once. Saturate first layer then overlap with next run and saturate again.
- System must be totally dry before the onset of freezing conditions.
- Over concrete surfaces follow the application instructions as outlined in this document, however, use Sealoflex fabric, not deck fabric over concrete.

For this and/or related products, please refer to individual product data sheets, System Application Guides, Products MSDS, Primer Chart, Fabric Chart.

**IMPORTANT NOTE:** Always check our website, [www.sealoflex.com](http://www.sealoflex.com) to determine if the printed literature you are reading is the most current version available.