

# 1.3.1.1 Decks with Hardwearing Color Finish

## Application Guide

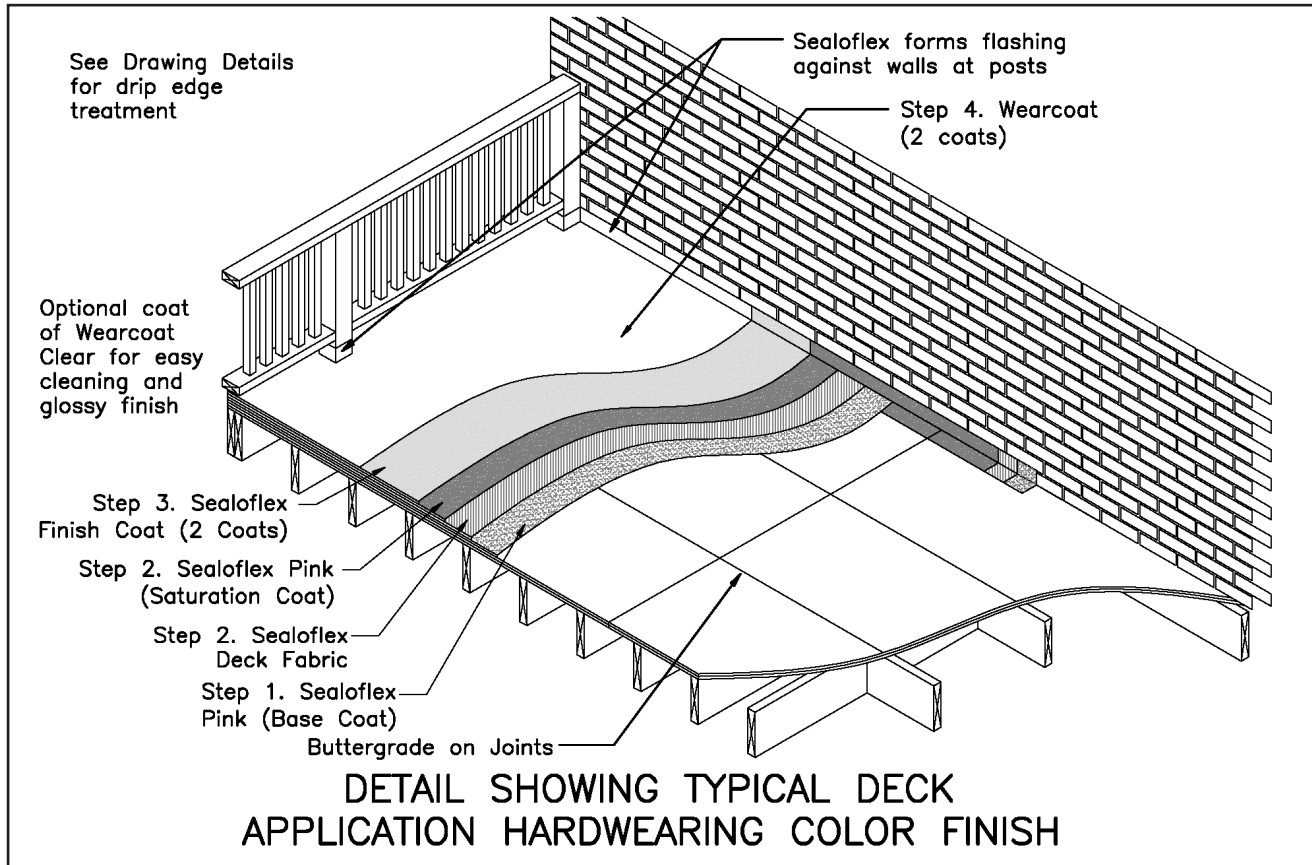

### Inspection

Inspect deck area carefully paying particular attention to the following points:

- Deck must have adequate slope to ensure proper drainage and no standing water
- Structural integrity of the deck

### Wooden Decks

- Ideally the structure should consist of 3/4" tongue and groove exterior grade plywood supported by joists at 16" centers and glued and screwed into position
- Joints in the plywood should be over support joists, to eliminate independent vertical movement of the boards

### Concrete Deck

- Where the substrate is reinforced concrete, the location of expansion joints is left to the discretion of the structural engineer.
- Where concrete toppings exist, 1/4" expansion joints should be present at least 10 feet on center to accommodate thermal movement and to avoid random cracking of the concrete below the Sealoflex application

**NOTE:** Low areas on both wood and concrete decks can be filled with Sealopatch™ prior to application of fabric reinforcement

### Preparation

Apply minimum 3/8" x 3/8" fillet of a single component polyurethane caulk at junctions of vertical and horizontal surfaces.

### Priming

Based on substrate and/or surface conditions primers will vary. Primers to consider are Dampseal 101™, Sealobond Primer™, Sealoment Plus™, Rust-X 2020™ and/or Metal Etch Primer™. Refer to Sealoflex Primer chart.

## SEALOFLEX INC.

### CORPORATE OFFICES

2520 Oscar Johnson Drive  
Charleston, SC 29405  
Tel: (843) 554-6466  
(800) 770-6466  
Fax: (843) 554-6458  
Website: [www.Sealoflex.com](http://www.Sealoflex.com)  
E-mail: [info@sealoflex.com](mailto:info@sealoflex.com)

### SALES OFFICE

CHARLESTON, SC  
HAMBURG, GERMANY  
CANTERBURY, KENT, U.K.



## Waterproofing Systems

### LIMITED WARRANTY

Sealoflex warrants its products to be free of manufacturing defects and that they will meet Sealoflex's current published physical properties when applied in accordance with Sealoflex's directions. There are no other warranties by Sealoflex of any nature whatsoever, expressed or implied, including any warranty of merchantability of fitness for a particular purpose in connection with this product. Sealoflex Inc. shall not be liable for damages of any sort, including remote or consequential damages, resulting from any claimed breach of any warranty whether expressed or implied, including any warranty of merchantability of fitness for a particular purpose or from any other cause whatsoever.

FEBRUARY 2010

### Application

- Flash junctions between deck and walls, posts and any other adjacent surfaces with Sealoflex fabric by applying a generous layer of Sealoflex Pink® 3" minimum up the vertical surface and 3" minimum onto the deck and immediately embed the fabric into the wet Sealoflex Pink® working in well with the paint brush and applying more Sealoflex Pink® to the surface to fully saturate the fabric. Allow to dry.
- Repair cracks or imperfections on wood and concrete using Sealoflex Buttergrade™ for minor repairs and Sealopatch™ for larger cavities. Smooth imperfections by applying Sealoflex Buttergrade™ to plywood seams, edges of flashing fabric and drip edge metal using a sheetrock knife or stainless steel trowel. Do not apply thicker than 1/8" at a time. Allow to dry. Sand with 80-100 grit sandpaper to achieve a smooth finish
- Apply a seal coat of Sealoflex Pink® to the entire horizontal area by 3/4" nap roller or airless spray at a rate of 100 sq.ft./gal. and allow to dry.

- For Wood Decks** Unroll the "Deck Fabric" a section at a time. Once the fabric is in position apply Sealoflex Pink® generously to the fabric surface with a brush, roller or airless spray equipment and backroll to ensure fabric is properly embedded. Application rate will be approximately 60 sq.ft./gal. Use roller to apply. Cover the entire horizontal area in this way and allow to dry. Adjacent runs of fabric must overlap by 3" minimum. Ensure that fabric overlaps are completely saturated.

**For Concrete Decks:** It is recommended that all concrete be tested for moisture content prior to application of the Sealoflex System.

Structural concrete moisture should be <8%.

Cellular Lightweight concrete moisture should be <19%.

**If the moisture content is greater than specified, it is recommended that Dampseal 101™ be applied.**

Apply a base coat of Sealoflex CT Pnk™ over area. While basecoat is still wet, embed Sealoflex Fabric™. Use a dry roof brush over the fabric to fully embed the fabric. Allow to dry. Apply saturation coat of Sealoflex CT Pink™. Allow to dry. Adjacent runs of fabric must overlap by 3" minimum. Ensure that overlaps of fabric are fully saturated.

- Once the Sealoflex Pink® is dry or the Sealoflex CT Pink™ (over cellular lightweight concrete) is dry, trim the excess fabric at the edges with a razor knife. If an overlap of the fabric was necessary, apply Sealoflex Buttergrade™ as described above. At this point, the deck should have a smooth uniform appearance showing only the grain of the fabric.
- Apply two generous coats of Sealoflex Finish Coat™ or Sealoflex CT Top™ (over cellular lightweight concrete) to the whole area and flashings using a roller or airless spray. Allow first coat to dry before applying second coat.
- Ensure that the Sealoflex System has cured before applying Wearcoat™. Apply two coats of Wearcoat™ by roller at the rate of 90 sq.ft./gal. (total for both coats).

**Note:** Wearcoat™ is available in smooth or non-skid finish. Please specify when placing your order.

- An optional coat of Wearcoat™ Clear may be applied to give the surface a more glossy appearance and easy cleaning.
- An attractive alternative finish to Wearcoat™ would be to apply Coraflex™ finish, over the Sealoflex waterproofing system. Allow to dry. Follow with 2 coats of Wearcoat™ clear over the Coraflex™. Use vinyl plastic removeable tape to create a decorative design prior to application of Coraflex™. Contact Sealoflex technical department for details. (Refer to application guide 1.3.1.5)

### Total product requirements for the project will be:

- Primer-Refer to Primer Chart
- Sealoflex Pink® 40 sq.ft./gal.
- Sealoflex Finish Coat™ 70 sq.ft./gal.
- Sealoflex Buttergrade™ 1 gal per 150 sq.ft. of deck area (approximately)
- 6" Sealoflex Fabric™ 300'/roll
- 40" Sealoflex Fabric™ 324'/roll
- 5' or 10' Deck Fabric 100 ft./roll
- Wearcoat™ 90 sq.ft./gal. (color of choice with or without sand aggregate)

### Equipment requirements for the project will be:

- Sheetrock knife or stainless steel trowel
- Sander with 80-100 grit sandpaper
- A good pair of scissors
- 3" paint brushes for flashings
- 3/4" nap rollers with long handles
- Airless sprayer (optional depending on project size)

### NOTES:

- Do not attempt to saturate two layers of fabric at the overlaps at once. Saturate first layer then overlap with next run and saturate again.
- System must be totally dry before the onset of freezing conditions.
- Over concrete surfaces follow the application instructions as outlined in the document, however, **use Sealoflex fabric, not deck fabric over concrete.**

For this and/or related products, please refer to individual product data sheets, System Application Guides, Products MSDS, Primer Chart, Fabric Chart.

**IMPORTANT NOTE:** Always check our website, [www.sealoflex.com](http://www.sealoflex.com) to determine if the printed literature you are reading is the most current version available.